

MANUFACTURED IN CALIF. U.S.A. UNDER THE FOLLOWING PATENTS:  
 4890398, 5137287, 5461290, 5471123, 5489275, 5543694, 5712548  
 U.S. AND FOREIGN PATENTS PENDING.

THIS DOCUMENT CONTAINS PROPRIETARY DATA OF POLARIS INDUSTRIAL ENTERPRISES, INC. DISCLOSURE, REPRODUCTION, OR USE OF ANY PART THERE OF MAY BE MADE EXCEPT BY WRITTEN PERMISSION.

REV.	BY	DATE	APPRVD.	P/N
				VA100

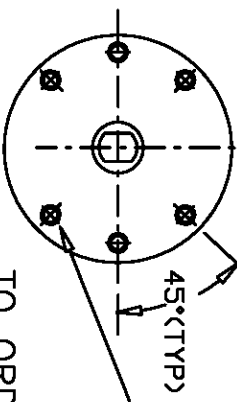
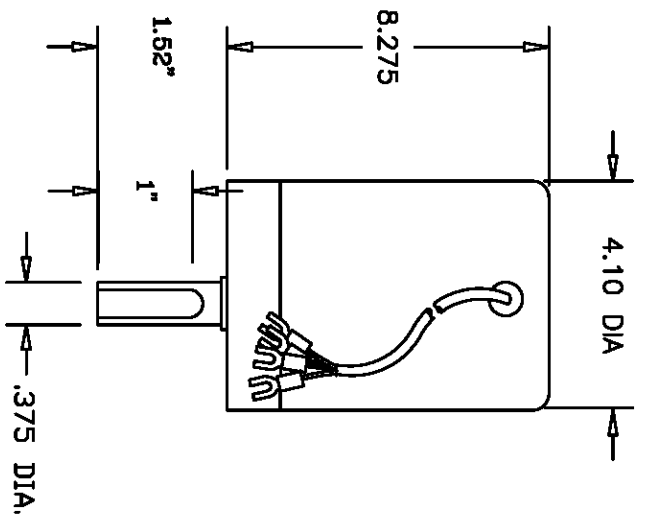
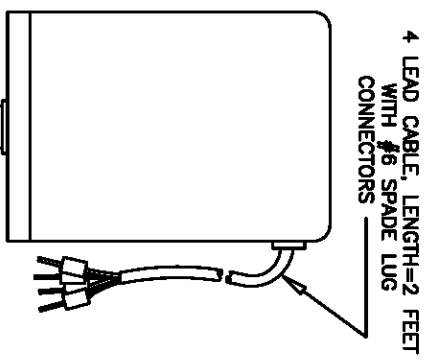

TO ORDER  
 MOUNTING HOLES  
 THREADED #10-32UNEF-2A  
 X 3/8 MIN. DEEP, 6 PLACES  
 DN 2.750 BOLT CIRCLE

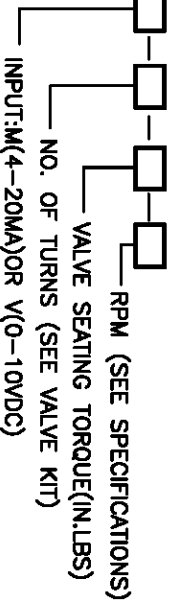

EXAMPLE: VA100M-8-15-5  
 MR OR VR (REVERSED ROTATION FOR REGULATORS)

FOR ISOLATED FEEDBACK POSITION OPTION

ORDER: VA100MF-8-15-5 (EXAMPLE)

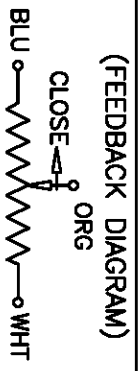

**SPECIFICATIONS:**

- ACTUATOR INPUT CURRENT: 4-20mA(M) OR 0-10VDC(V)
- INPUT IMPEDANCE: 200 OHMS(M) OR 18,000 OHMS(V)
- RPM: 1.5-3-5-10
- POWER REQUIRED: 24 VDC/50 WATTS MIN
- DYNAMIC BRAKING: INSTALLED
- LIMIT SWITCHES: INSTALLED
- MICRO-PROCESSOR: INSTALLED
- TORQUE LIMITER: FACTORY SET FOR SIZE OF VALVE ORDERED. OR APPROX. 100 IN.LBS MAX.
- SEATING TORQUE: FACTORY SET TO PREVENT VALVE SEAT DAMAGE OR SET TO CUSTOMERS SPECIFICATION. OCCURS IN THE LAST 30° ROTATION. UNLESS VALVE CHOSEN DOES NOT REQUIRE CLOSURE.

**ENVIRONMENTAL:**

- OPERATING TEMPERATURE: -30°C TO +85°C
- MOISTURE: SEALED AND SPLASH PROOF
- INSULATION RESISTANCE: 100 MEGOHMS @ 500 VDC
- DIELECTRIC STRENGTH: 500 VAC
- WEIGHT: 7.0 LBS. APPROX.

**MATERIAL:**

- COVER: SATIN ANODIZED ALUMINUM
- BASE: ANODIZED ALUMINUM
- OUTPUT SHAFT: STAINLESS STEEL
- CABLE: 22 GAUGE VINYL SLEEVE
- SCREWS: STAINLESS STEEL

**VALVE KIT:**

[ORDERED SEPARATELY, MOUNTED TO ACTUATOR AT ETI SYSTEMS] INCLUDES VALVE, BRACKET, COUPLER AND HARDWARE, IF NOT MOUNTED.

**ACTUATOR MOUNTED TO VALVE KIT**

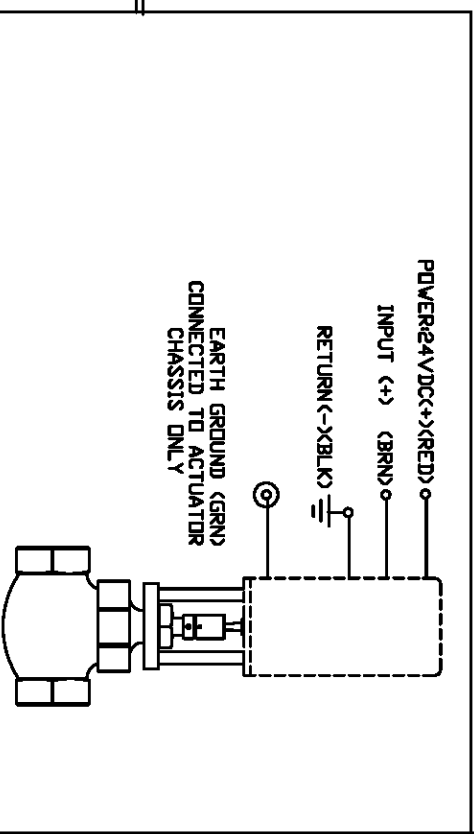

ALL SPECIFICATIONS SUBJECT TO CHANGE WITHOUT NOTICE.  
 TOLERANCES: XX = +/- .010" FRACT. = +/- 1/64"  
 XXX = +/- .005" ANGLES = +/- 1/2"  
 UNLESS OTHERWISE SPECIFIED

SCALE	DATE:	BY	AT
	7-15-05		
APPRVD			



TITLE: VALVE ACTUATOR

PART NO.: VA100