

MANUFACTURED IN CALIF. U.S.A. UNDER THE FOLLOWING PATENTS: 4800308, 5137257, 5461290, 5471223, 5486275, 5548524, 5712548, 5486275, 5548524, 5712548. U.S. AND FOREIGN PATENTS PENDING.

REV.	BY	DATE	APPRVD.	P/N
F	GC	12/20/00	BT	VA21

4 LEAD CABLE LENGTH=2 FEET WITH #6 SPADE LUG CONNECTORS

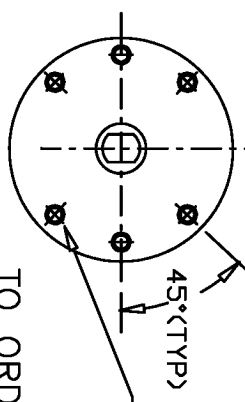
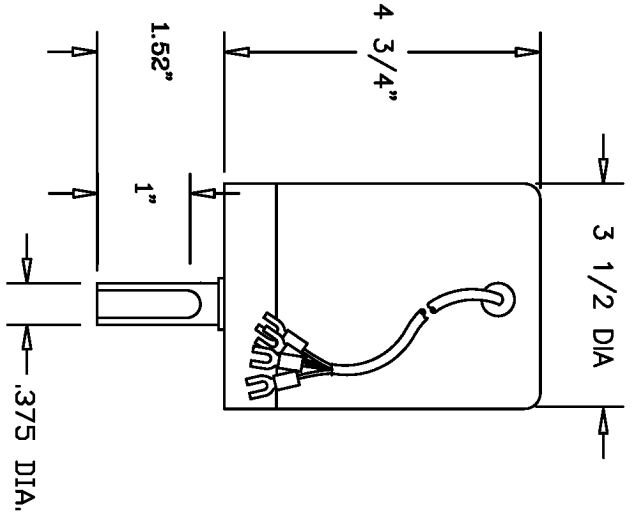
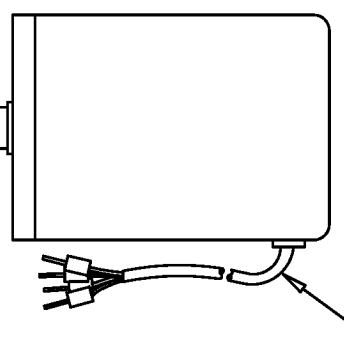

MOUNTING HOLES THREADED #10-32UNEF-2A X 3/8 MIN. DEEP, 6 PLACES DN 2.750Ø BOLT CIRCLE

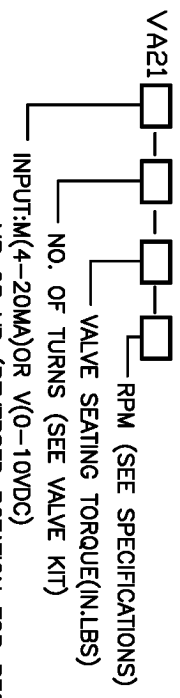

EXAMPLE: VA21M-8-15-5

FOR ISOLATED FEEDBACK POSITION OPTION

ORDER: VA21MF-8-15-5 (EXAMPLE)

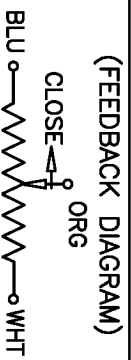

SPECIFICATIONS:

- ACTUATOR INPUT CURRENT ----- 4-20mA(M)OR 0-10VDC(V)
- INPUT IMPEDANCE ----- 200 OHMS(M)OR 18,000 OHMS(V)
- RPM ----- 1.5-3-5-10-20-40
- POWER REQUIRED ----- 24 VDC/50 WATTS MIN
- DYNAMIC BRAKING ----- INSTALLED
- LIMIT SWITCHES ----- INSTALLED
- MICRO-PROCESSOR ----- INSTALLED
- TORQUE LIMITER ----- FACTORY SET FOR SIZE OF VALVE ORDERED. OR APPROX. 21 IN.LBS MAX.
- SEATING TORQUE ----- FACTORY SET TO PREVENT VALVE SEAT DAMAGE OR SET TO CUSTOMERS SPECIFICATION. OCCURS IN THE LAST 30° ROTATION. UNLESS VALVE CHOSEN DOES NOT REQUIRE CLOSURE.

ENVIRONMENTAL:

- OPERATING TEMPERATURE ----- -30C TO +85C
- MOISTURE ----- SEALED AND SPLASH PROOF
- INSULATION RESISTANCE ----- 100 MEGOHMS @ 500 VDC
- DIELECTRIC STRENGTH ----- 500 VAC
- WEIGHT ----- 2.5 LBS. APPROX.

MATERIAL:

- COVER ----- SATIN ANODIZED ALUMINUM
- BASE ----- ANODIZED ALUMINUM
- OUTPUT SHAFT ----- STAINLESS STEEL
- CABLE ----- 22 GAUGE,VINYL SLEEVE
- SCREWS ----- STAINLESS STEEL

VALVE KIT:

[ORDERED SEPERATELY, MOUNTED TO ACTUATOR AT ETI SYSTEMS] INCLUDES VALVE, BRACKET, COUPLER AND HARDWARE, IF NOT MOUNTED.

ACTUATOR MOUNTED TO VALVE KIT

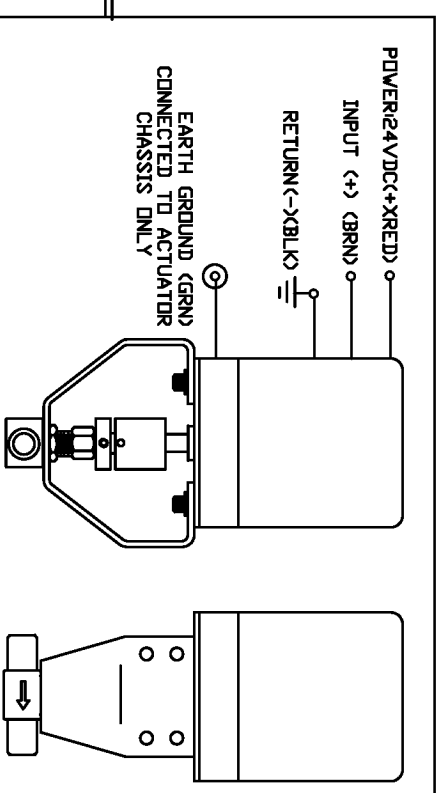

TOLERANCES

XX = +/- .010" FRACT. = +/- 1/64"

XXX = +/- .005" ANGLES = +/- 1/2"

ALL SPECIFICATIONS SUBJECT TO CHANGE WITHOUT NOTICE.

DATE: 01-10-99

BY: BT

APPRVD: BT

SCALE: 1:1

CODE IDENT: 19477

USED: DN



TITLE: VALVE ACTUATOR

PART NO.: VA21